

TAPCO® E-Z Angle®

Setup Instructions and Parts List

SIDING TABLE

Includes self-storing 5 foot long work support

Constructed with weather resistant anodized alloys for maximum strength, durability and portability.

Patent pending design always cuts through center of fixed back fence eliminating need for adjustments.

E-Z Angle does what no other siding table can

- Patent pending design allows cuts of 75° on 10" width stock, 72° on 12" width stock.
- Cross cuts up to 42" wide.
- Rip cuts up to 48" wide any length.
- Single handle controls all settings.

Folds to a compact 25" x 72" and weighs only 80 lbs. for easy transport.

Optional Pro-Stand

- Anodized aluminum construction
- Height adjustable from 28"-37"
- Heavy Duty Wheels
- Detaches quickly and folds for easy transport

Retractable work support with fence attaches to either end of table

Built-in Protractor and Pitch Conversion Scale.

Adjustable Saw Track Carriage for added stability.

Pro-Stand's heavy duty wheels convert to support pads

Fully captured and locking Saw Plate, for accuracy and added safety. Accepts most 7 1/4" or 8 1/4" (184mm, 210mm) full shoe circular saws. Also accommodates routers.

Optional Extension Tables available to increase table capacity in width or length.

Adjustable Material Stop flips out of your way when not in use.

Leg Brackets "capture" and "lock" onto most saw horses or lay flat on any surface.

E-Z Angle Siding Table shown on Tapco Pro-Stand (Saw and Pro-Stand sold separately)

Tape measures along entire length of Saw Tracks and Fence.

16" x 72" reversible Polytop work surface for precise burr-free cuts.

E-Z Angle Set up instructions

U.S. & Foreign Patents Pend.

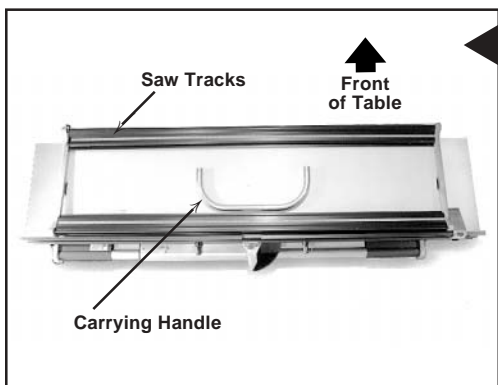

1 Remove the Carrying Handle and Saw Tracks from their storage position and set aside.

Turn the table on its side as pictured and unscrew the Lock Knob to release Carriage Base Track from its storage position.

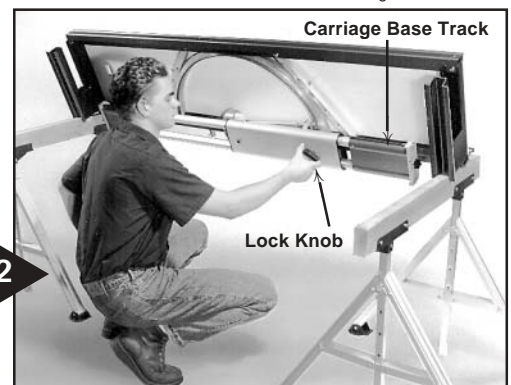

3 Tooth Clip Bracket and Carriage Base Track which both rotate freely should now be brought together.

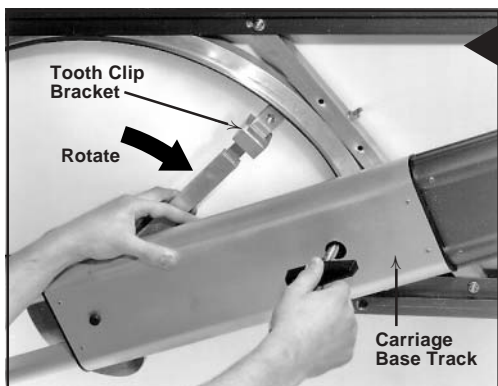

Align the threaded hole in the Tooth Clip Bracket with the Lock Knob of the Carriage Base Track and screw into place.



E-Z Angle® PARTS LIST

CAUTION

When retracted fully into the table, the back rail of the material support will block the back fence opening. You MUST extend the Retractable Material Support past the opening before operating your saw.

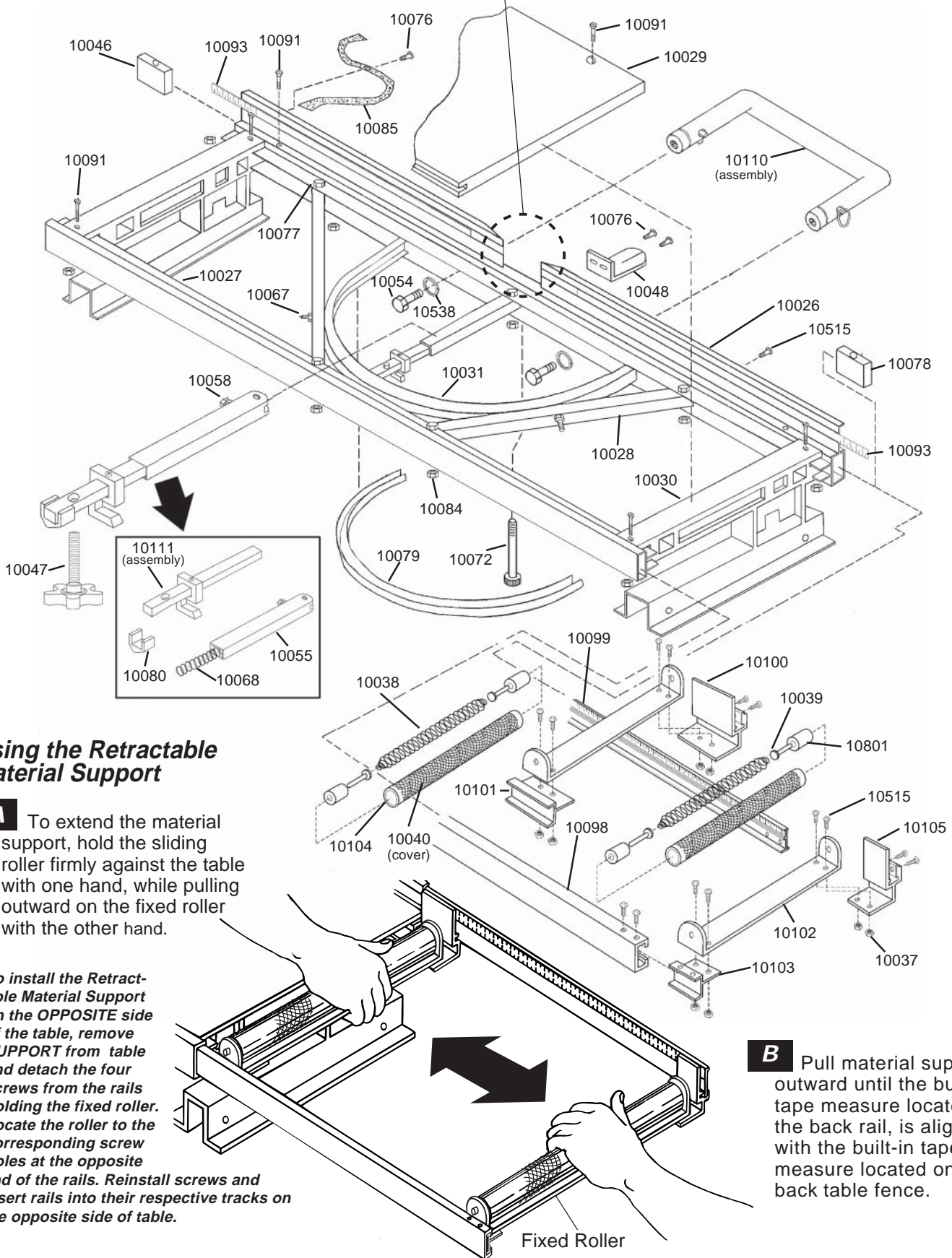

Part No.	Part Name
10026	Rear Fence
10027	Front Rail
10028	Table Strut
10029	Work Surface
10030	Mounting Bracket
10031	Protractor Support
10043	Saw Guides
10045	1/4-20 X 2" Phil FL HD Sc
10046	Pivot Block
10047	Carriage Assem Locking Knob
10048	Protractor Indicator
10049	End Casting

Part No.	Part Name
10050	T Casting
10051	Saw Track Vinyl
10052	Protractor
10054	3/8-16 X 1 1/2" Hex Bolt
10055	Inside Locking Tube
10058	1/4-20 X 1" Hex Wash HD Sc
10065	Saw Clip
10066	Saw Plate
10067	1/4-20 X 1 3/4" Stud
10068	Lock Spring
10072	3/8 x 3 1/2" Shoulder Bolt
10073	1/4-20 x 2" Hex Bolt
10074	8/32 x 5/16" Phil FL HD Sc
10075	Saw Plate Lock Knob
10076	10-24 X 3/4" Phil Pan HD Sc
10077	1/4-20 X 1 1/2" Hex Cap Sc
10078	Storage Block
10079	Protractor Support Vinyl
10080	Tooth Pad
10081	T-Knob
10083	Stop Plunger
10084	1/4-20 2 Way Lock Nut
10085	Velcro Retaining Strap
10089	1/4-20 X 1 1/2" Socket Cap Sc
10090	10-24 X 1/2" Phil FL HD Sc
10091	1/4-20 X 2" Phil FL HD Sc
10092	Plate Lock
10093	Tape Measure
10094	1/4-20 Hex Flange Nut
10095	1/4" Flat Washer

Part No.	Part Name
10096	1/4-20 Wing Nut
10097	Plate Lock Spring
10108	Carriage Assembly
10110	Handle Assembly
10111	Locking Assembly
10113	Material Stop with Knob
10115	Replacement Saw Plate Assembly
10121	Extension Arm
10515	10-24 X 1/2" Pan HD Sc
10531	Hemming Handle Plug
10534	3/8" Flat Washer
10538	3/8" Lock Washer
10539	1/4 X 1 1/4" Faspin
10759	10-24 X 5/8" Phil Pan HD Sc
10766	1/4-20 X 1" Knurled Knob
Extension Arm Components	
10037	10-24 Nylok Hex Nut
10038	Roller Spring
10039	Roller Stud
10040	Roller Cover
10098	Front Rail
10099	Back Rail
10100	Back Rail Bracket
10101	Front Rail Bracket
10102	Roller Bracket
10103	Fixed Roller Bracket
10104	Table Roller
10105	Fixed Rear Bracket
10515	10-24 X 1/2" Pan HD Sc
10801	Roller Tube Insert

INSTALLATION-SAW PLATE STOP PLUNGER

Hand thread stop plunger into the hold location in the "T" casting until the plunger pin is fully visible from the top of the "T" casting. Care must be taken when using pliers as damage to the unit may affect its performance. Use light lubricants needed.

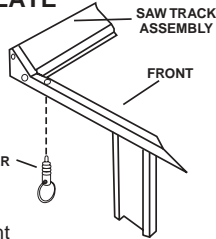

NOTE: To release saw plate, pull plunger ring and rotate 90°

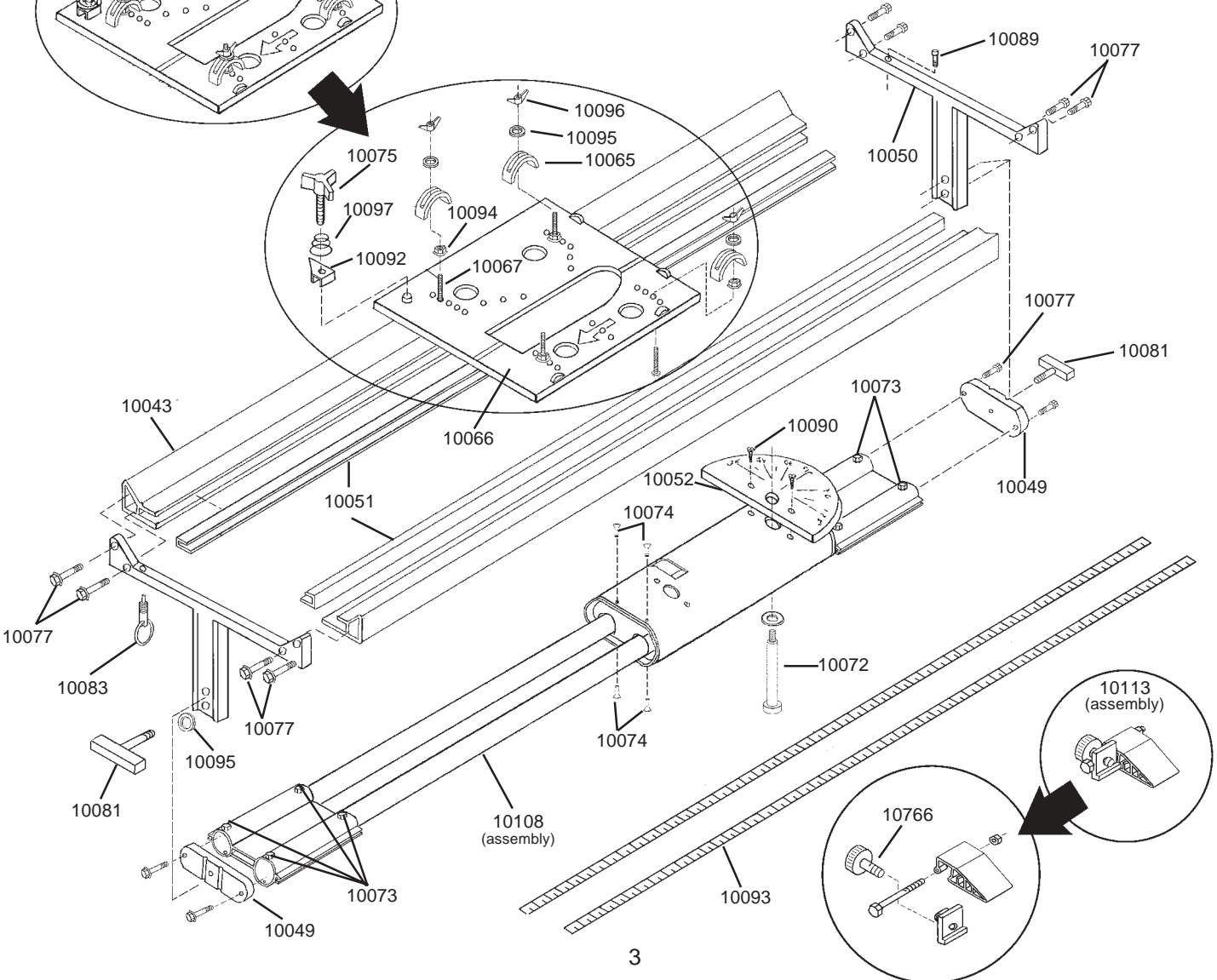
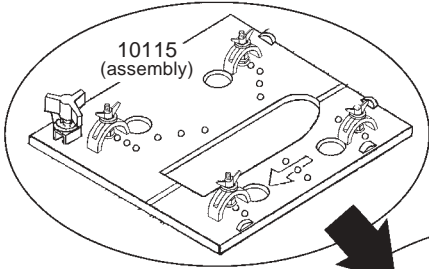

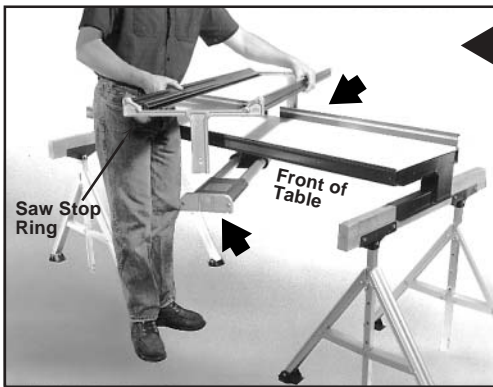

5 Turn table right side up and connect end supports of Saw Tracks with slots on Carriage Base Track.

Note: Saw Track end support with Saw Stop Ring must be on FRONT side of table.

Use Locking Knob and washer provided to secure Saw Tracks in top hole for 7 1/4" saw or bottom hole for 8 1/4" saw.

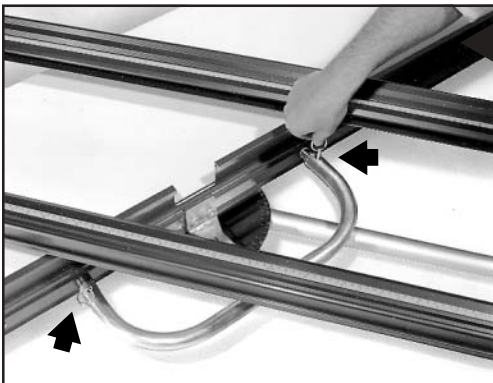
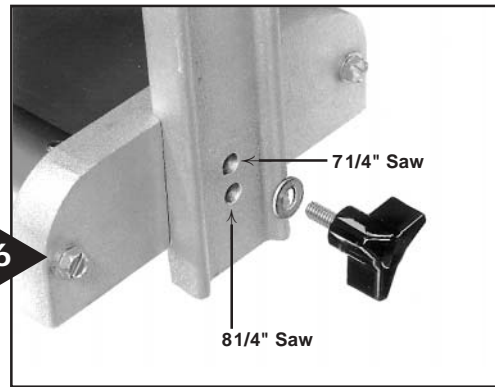

7 Install Carrying Handle by inserting it into the Handle Plugs on the back of the table and securing it with the Faspins provided.

To install your saw on Saw Plate, line the zero degree marks on the shoe of your saw with the index lines on the middle of the Saw Plate and note where holes for Saw Clip Studs line up.

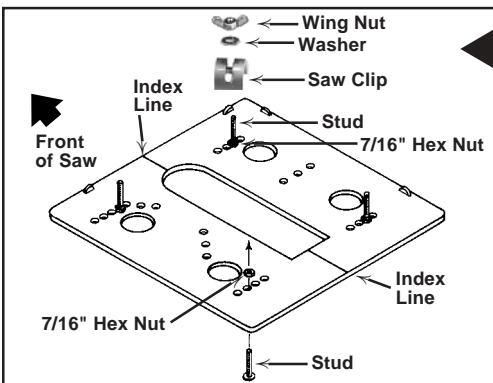
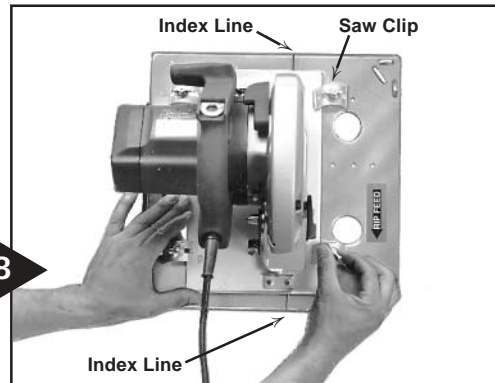

9 Once the saw is aligned properly, attach the (4) Saw Clip assemblies as indicated and secure your saw in place.

Note: Saw Stop Ring located on end of Saw Track must be retracted to insert Saw Plate into Saw Tracks.

To square the Saw Tracks place a framing square along the Back Fence and align it with the Saw Track.



Then set Indicator Mark on Protractor to zero by loosening screws and sliding Indicator Plate to zero mark.

Note: Work Support attaches to either end of Table in seconds. Use Velcro® strap to store for transport.

For further information regarding set up and operations of your E-Z Angle Siding Table refer to the E-Z Angle "Assembly and Operating Video" included.

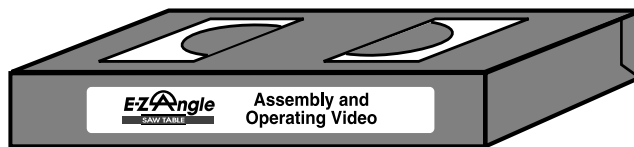

The recommended saw for the E-Z Angle Siding Table is the SkilSaw Professional Model 5657

HANDLING INSTRUCTIONS: Always use Carrying Handle when carrying Table and always tighten Lock Knob controlling Carriage Base Track. Failure to do so may damage Siding Table and cause personal injury.

TRANSPORTATION INSTRUCTIONS: When transporting, remove saw from Table and remove Table from stand. Then lay Table flat in bed of truck and secure it to vehicle. Always use two people to load and unload.

GENERAL CARE AND MAINTENANCE: Prior to use, check all screws, bolts and nuts. Check Saw Tracks and Protractor for alignment. Check table surface for possible replacement and locking mechanism for proper operation. Check alignment of saw on Saw Plate.

Always follow general safety rules for saw tables and read your circular saw or router safety rules and operating instructions before using them with the E-Z Angle Siding Table.

CAUTION:

- Always use safety goggles.
- Always operate on level ground to avoid tipping.
- Because of sparks, do not use near flammable materials.
- Be aware that saw kickback may occur at any time.
- Saw Plate must be locked in place before performing rip cutting operations
- The use of any other accessories not specified in this manual may create a hazard.
- Product made of aluminum alloy, sharp edges can occur, use caution.



TAPCO PRODUCTS COMPANY

45657 Port Street • Plymouth, Michigan, U.S.A. 48170-6010 • Telephone: (734) 451-8272 • Fax: (734) 451-0702